

GenII People counter

Eltek

SPECIALIST
DATA LOGGERS

Easy to use customised data loggers

The GenII people counter system consists of the self powered GC62 transmitter to which the pulse output from a Velleman PEM7D can be connected. The PEM7D is a compact AC mains powered device that emits a continuous infrared beam. The sender and receiver are contained in a single compact enclosure that produces a pulse if the reflected beam is interrupted. The range is given as 7M.

The PEM7D is supplied with adjustment bracket, reflector, AC100/250 to 9VDC fixing hardware and setting up instructions.

The PEM7D is supplied with a captive 9.0M lead where:
 Black is -ve,
 Red is +9VDC
 White is the output (0V if beam is detected.)

The lead could be extended if required.
 In the event of AC failure the counter will not function.

Operational temperature range : -20 to +50 degrees C.
 Battery endurance: >2 years at 5 minute transmit interval.

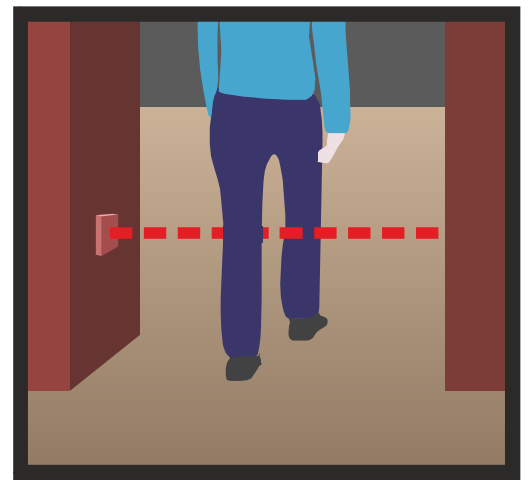
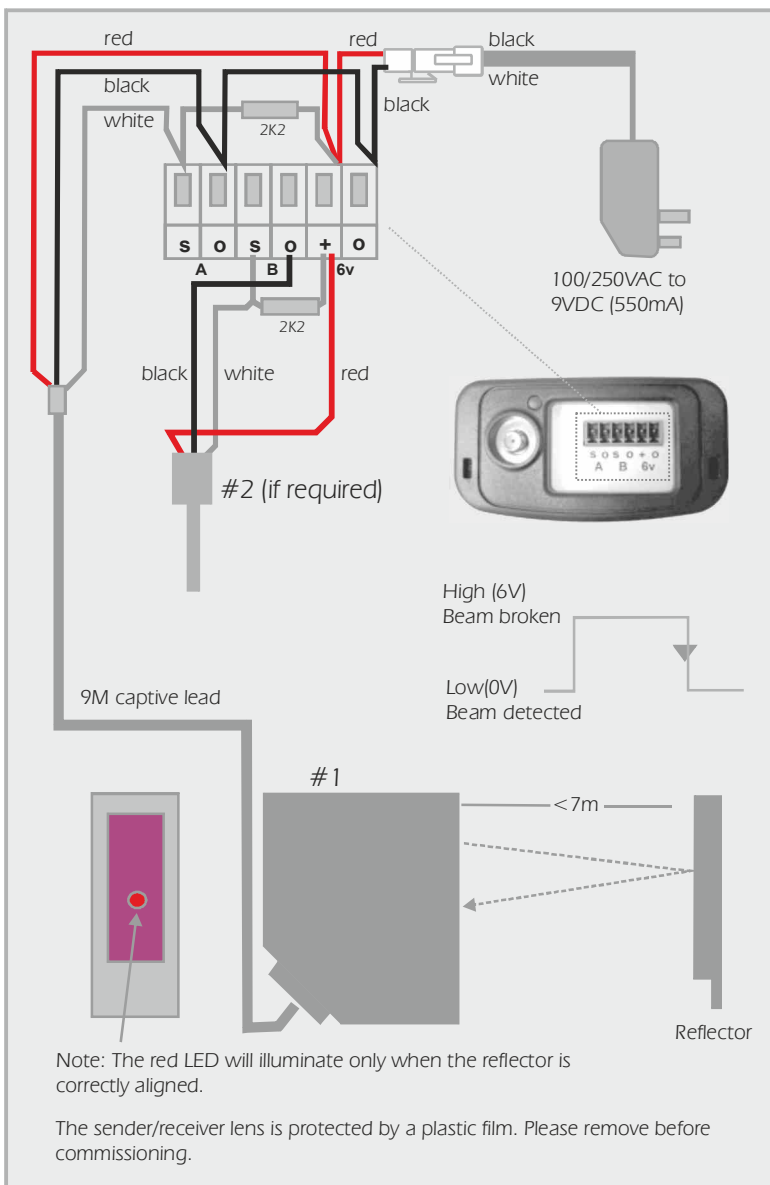

The GC62 has two counter inputs.

Each GC62 input increments the (pulse) counter by 1 at each high to low transition.

The PEM7D outputs a low (0V) when the beam is detected and high (9V) (person passing) when the beam is interrupted.

The GC62 counts to 65,535. When the maximum is reached the counter resets to zero and starts again. The logger detects the rollover and commences to add the new count value to the last, providing a continuous total value until the user forces a reset.

Eltek

Specialist Data Loggers
 Eltek Ltd, 35 Barton Road, Haslingfield
 Cambridge, CB23 1LL, England
 Tel: +44 (0) 1223 872111
 Fax: +44 (0) 1223 872521
 email: sales@eltekdataloggers.co.uk
<http://www.eltekdataloggers.co.uk>

CE **Guarantee:** Equipment manufactured by Eltek is guaranteed against faulty materials or workmanship for three years. For repairs carried out under guarantee, no charge is made for labour, materials or return carriage.